



TouchFLO™ 3D

TouchFLO 3D gives you touch control over your Windows Mobile-powered device.

To navigate the TouchFLO 3D Home screen:



- 1 Press and hold on the active tab.
- 2 Slide your finger right or left over the tabs.
- 3 Release when you have selected the desired tab.

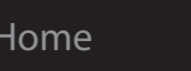

Home

On the **Home** tab, a large flip-style clock prominently displays the time. You can also see missed calls and new appointments.

Touch the date or the clock to open the Clock & Alarms screen where you can set the date, time, and alarm.

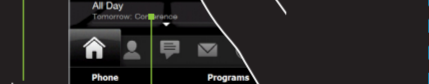

Touch here to view details of your missed calls.
Touch an appointment to view details of the appointment.



People

On the **People** tab, you can add favorite contacts you most frequently communicate with.

- 1 Touch the big **Plus** icon on the screen.
- 2 On the Select a Contact screen, touch the name of the desired contact.
- 3 Select a phone number or an e-mail address to associate to the favorite contact.
- 4 To add another favorite contact, touch the small **Plus** icon (**+**) on the right and repeat steps 2 and 3.

Tip You can add up to 15 favorite contacts.

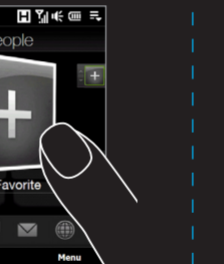

Messages

On the **Messages** tab, you can read SMS messages as they arrive and create a new SMS message. You can also view the text of received MMS messages in this tab.

- 1 To flip through received SMS and MMS messages, swipe upward or downward on the screen or touch the Up/Down arrow.
- 2 To reply, touch the message that is displayed on the screen.

Or, to create a new SMS message, touch the **New** icon ().

Tip Touch **All Messages** to access all SMS and MMS messages in your inbox and other folders.

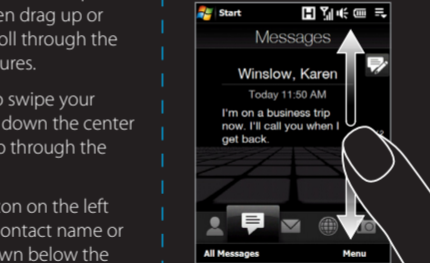

Mail

The **Mail** tab is where you send and receive e-mail messages. You can add up to four e-mail accounts on this tab.

Note For instructions on setting up e-mail accounts, see the printed Quick Start Guide and the User Guide in the Getting Started Disc.

- 1 Touch an icon on the right to select an e-mail account.
- 2 To browse through received e-mails, swipe up or down on the envelope image.
- 3 Touch the displayed e-mail on the screen to read and reply to that e-mail.

Or, touch the **New Mail** icon () to create and send a new e-mail.

Tip Touch the contact picture on the center screen to access detailed contact information.

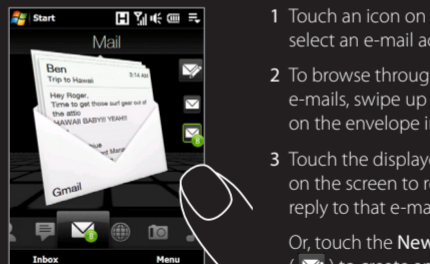

Photos and Videos

On this tab, visually flip through your photos and video clips and view them in full screen. You can also activate the Camera so you can take pictures and record video clips.

- 1 Touch the photo or video on the screen to view or play it in full screen.
- 2 To flip through photos and videos, swipe upward or downward on the center screen or touch the Up/Down arrow.

Touch here to take a photo.
Touch here to record video.

Slide your finger clockwise to zoom in.
Slide your finger counter-clockwise to zoom out.

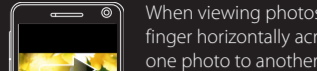
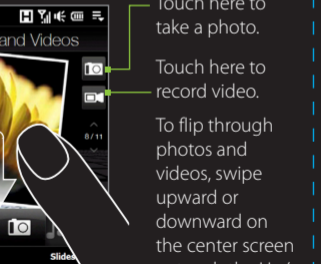

When viewing photos in full screen, swipe your finger horizontally across the screen to go from one photo to another.
Automatically rotate the photo by simply turning your device sideways.



Slide your finger clockwise to zoom in.



Slide your finger counter-clockwise to zoom out.



Music

The **Music** tab allows you to visually browse through music albums and play music.



- 1 To flip through albums and music tracks in an album, swipe your finger upward or downward on the album covers or touch the arrow icons.
- 2 Touch to play, to pause.

Tip Touch **Menu** to set music playback to repeat and turn shuffle mode on or off.

To advance forward/backward in the current music, touch and hold on this bar to display the progress bar and then drag right or left.

You can also browse and play music in the Library. The Library organizes your music into categories such as title, artist, genre, and more.

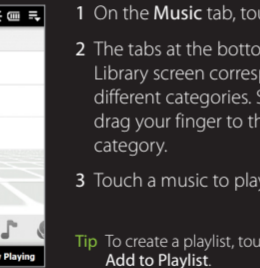

- 1 On the **Music** tab, touch **Library**.
- 2 The tabs at the bottom of the Library screen correspond to different categories. Slide and drag your finger to the desired category.
- 3 Touch a music to play it.

Tip To create a playlist, touch **Menu** > **Add to Playlist**.

Internet

On the **Internet** tab, you can open Opera® Mobile and browse the web.



Swipe your finger upward to scroll down the screen and access more web favorites.

Touch here to browse the web using Opera® Mobile.

Touch **All Bookmarks** to add or delete web favorites.

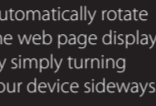

Automatically rotate the web page display by simply turning your device sideways.

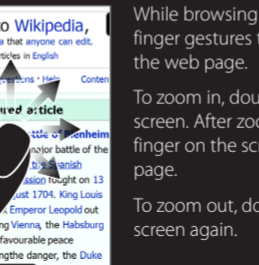

While browsing web pages, use finger gestures to pan and zoom on the web page.

To zoom in, double-tap on the screen. After zooming, drag your finger on the screen to pan the web page.

To zoom out, double-tap on the screen again.

Weather

On the **Weather** tab, you can check your local weather as well as the weather for cities around the globe.



Touch here to download the latest weather information.

To see the weather information for the next five days of the week, touch **5-day**.

To switch between cities, swipe your finger upward/downward or touch the Up/Down arrow.

Tip Touch **Menu** to change the temperature to Celsius or Fahrenheit.

You can add up to 10 cities on the **Weather** tab.

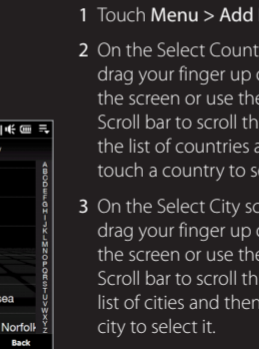

- 1 Touch **Menu** > **Add Location**.
- 2 On the Select Country screen, drag your finger up or down the screen or use the Quick Scroll bar to scroll through the list of countries and then touch a country to select it.
- 3 On the Select City screen, drag your finger up or down the screen or use the Quick Scroll bar to scroll through the list of cities and then touch a city to select it.

Settings

The **Settings** tab allows you to synchronize information with your computer or the Exchange Server, change sound settings such as the ring tone, and choose a different wallpaper for the **Home** tab. You can also easily turn on and off the communications features of your device such as Wi-Fi, Bluetooth, and more.



Programs

On the **Programs** tab, you can add your favorite programs for one-touch access.

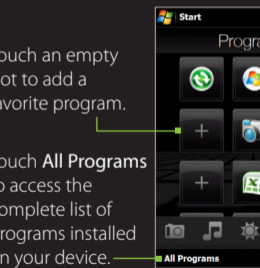

Touch an empty slot to add a favorite program.

Touch **All Programs** to access the complete list of programs installed on your device.

Note To replace a slot with another program, you must delete the occupying program shortcut first and then add your desired program.

Touch a program icon to open the corresponding program.

Touch **Remove** to choose which program to remove from the Programs tab.